

C-KC

超硬ソリッドキーシードカッター

Carbide Solid Woodruff Key-Seat Cutter



在庫がなくなった寸法より先ムクからソリッドに変更しております。

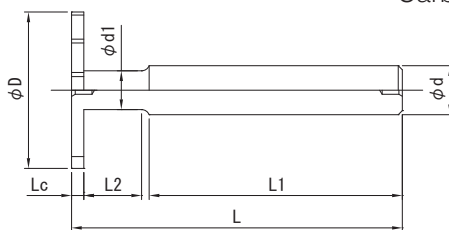

外径許容差(φD) 10以上 30以下 0～+0.05
30を超え 50以下 0～+0.07
刃幅許容差(Lc) 外径 10以上 30以下 -0.012～0
外径 30を超え 50以下 -0.018～0

Z20

外径 φD	刃幅 Lc	柄径 φd	柄長 (L1)	首径 φd1	首長(フラット) L2	全長 L	刃数
10	0.4	8	74.2	4.5	7	85	8
10	0.5	8	74.1	4.5	7	85	8
10	0.6	8	74	4.5	7	85	8
10	0.7	8	73.9	4.5	7	85	8
10	0.8	8	73.8	4.5	7	85	8
10	0.9	8	73.7	4.5	7	85	8
10	1	8	73.6	4.5	7	85	8
10	1.1	8	73.5	4.5	7	85	8
10	1.2	8	73.4	4.5	7	85	8
10	1.3	8	73.3	4.5	7	85	8
10	1.4	8	73.2	4.5	7	85	8
10	1.5	8	73.1	4.5	7	85	8
10	1.6	8	73	4.5	7	85	8
10	1.7	8	72.9	4.5	7	85	8
10	1.8	8	72.8	4.5	7	85	8
10	1.9	8	72.7	4.5	7	85	8
10	2	8	72.6	4.5	7	85	8
10	2.1	8	72.5	4.5	7	85	8
10	2.2	8	72.4	4.5	7	85	8
10	2.3	8	72.3	4.5	7	85	8
10	2.4	8	72.2	4.5	7	85	8
10	2.5	8	72.1	4.5	7	85	8
10	2.6	8	72	4.5	7	85	8
10	2.7	8	71.9	4.5	7	85	8
10	2.8	8	71.8	4.5	7	85	8
10	2.9	8	71.7	4.5	7	85	8
10	3	8	71.6	4.5	7	85	8
10	3.5	8	71.1	4.5	7	85	8
10	4	8	70.6	4.5	7	85	8
10	5	8	69.6	4.5	7	85	8
12	0.4	10	73.5	5	7	85	8
12	0.5	10	73.4	5	7	85	8
12	0.6	10	73.3	5	7	85	8
12	0.7	10	73.2	5	7	85	8
12	0.8	10	73.1	5	7	85	8
12	0.9	10	73	5	7	85	8
12	1	10	72.9	5	7	85	8
12	1.1	10	72.8	5	7	85	8
12	1.2	10	72.7	5	7	85	8
12	1.3	10	72.6	5	7	85	8
12	1.4	10	72.5	5	7	85	8

被削材種 型番	鋳物	炭素鋼	合金鋼	工具鋼	調質鋼	ステンレス鋼	アルミ合金	銅合金	チタン合金	耐熱合金
	FC,FCD	S45C	SCM	SKD	NAK,HPM	SUS	Al	Cu	Ti6Al4V	インコネル
硬度	~200HB	~200HB	~250HB	~35HRC	~45HRC					
C-KC	○	○	○	○	△	○	○	○		

切削条件 P.293

C-KC

超硬ソリッドキーシードカッター

Carbide Solid Woodruff Key-Seat Cutter

外径 φ D	刃幅 L c	柄径 φ d	柄長 (L 1)	首径 φ d 1	首長 (フラット) L 2	全長 L	刃数
12	1.5	10	72.4	5	7	85	8
12	1.6	10	72.3	5	7	85	8
12	1.7	10	72.2	5	7	85	8
12	1.8	10	72.1	5	7	85	8
12	1.9	10	72	5	7	85	8
12	2	10	71.9	5	7	85	8
12	2.1	10	71.8	5	7	85	8
12	2.2	10	71.7	5	7	85	8
12	2.3	10	71.6	5	7	85	8
12	2.4	10	71.5	5	7	85	8
12	2.5	10	71.4	5	7	85	8
12	2.6	10	71.3	5	7	85	8
12	2.7	10	71.2	5	7	85	8
12	2.8	10	71.1	5	7	85	8
12	2.9	10	71	5	7	85	8
12	3	10	70.9	5	7	85	8
12	3.5	10	70.4	5	7	85	8
12	4	10	69.9	5	7	85	8
12	5	10	68.9	5	7	85	8
13	0.4	10	73.7	5.5	7	85	8
13	0.5	10	73.6	5.5	7	85	8
13	0.6	10	73.5	5.5	7	85	8
13	0.7	10	73.4	5.5	7	85	8
13	0.8	10	73.3	5.5	7	85	8
13	0.9	10	73.2	5.5	7	85	8
13	1	10	73.1	5.5	7	85	8
13	1.1	10	73	5.5	7	85	8
13	1.2	10	72.9	5.5	7	85	8
13	1.3	10	72.8	5.5	7	85	8
13	1.4	10	72.7	5.5	7	85	8
13	1.5	10	72.6	5.5	7	85	8
13	1.6	10	72.5	5.5	7	85	8
13	1.7	10	72.4	5.5	7	85	8
13	1.8	10	72.3	5.5	7	85	8
13	1.9	10	72.2	5.5	7	85	8
13	2	10	72.1	5.5	7	85	8
13	2.1	10	72	5.5	7	85	8
13	2.2	10	71.9	5.5	7	85	8
13	2.3	10	71.8	5.5	7	85	8
13	2.4	10	71.7	5.5	7	85	8
13	2.5	10	71.6	5.5	7	85	8
13	2.6	10	71.5	5.5	7	85	8
13	2.7	10	71.4	5.5	7	85	8
13	2.8	10	71.3	5.5	7	85	8
13	2.9	10	71.2	5.5	7	85	8
13	3	10	71.1	5.5	7	85	8
13	3.5	10	70.6	5.5	7	85	8
13	4	10	70.1	5.5	7	85	8
13	5	10	69.1	5.5	7	85	8
15	0.4	10	78.8	6	7	90	10
15	0.5	10	78.7	6	7	90	10
15	0.6	10	78.6	6	7	90	10
15	0.7	10	78.5	6	7	90	10
15	0.8	10	78.4	6	7	90	10
15	0.9	10	78.3	6	7	90	10
15	1	10	78.2	6	7	90	10
15	1.1	10	78.1	6	7	90	10

C-KC

超硬ソリッドキーシードカッター

Carbide Solid Woodruff Key-Seat Cutter

外径 φ D	刃幅 L c	柄径 φ d	柄長 (L 1)	首径 φ d 1	首長 (フラット) L 2	全長 L	刃数
15	1.2	10	78	6	7	90	10
15	1.3	10	77.9	6	7	90	10
15	1.4	10	77.8	6	7	90	10
15	1.5	10	77.7	6	7	90	10
15	1.6	10	77.6	6	7	90	10
15	1.7	10	77.5	6	7	90	10
15	1.8	10	77.4	6	7	90	10
15	1.9	10	77.3	6	7	90	10
15	2	10	77.2	6	7	90	10
15	2.1	10	77.1	6	7	90	10
15	2.2	10	77	6	7	90	10
15	2.3	10	76.9	6	7	90	10
15	2.4	10	76.8	6	7	90	10
15	2.5	10	76.7	6	7	90	10
15	2.6	10	76.6	6	7	90	10
15	2.7	10	76.5	6	7	90	10
15	2.8	10	76.4	6	7	90	10
15	2.9	10	76.3	6	7	90	10
15	3	10	76.2	6	7	90	10
15	3.5	10	75.7	6	7	90	10
15	4	10	75.2	6	7	90	10
15	5	10	74.2	6	7	90	10
16	0.4	10	79.2	6.5	7	90	10
16	0.5	10	79.1	6.5	7	90	10
16	0.6	10	79	6.5	7	90	10
16	0.7	10	78.9	6.5	7	90	10
16	0.8	10	78.8	6.5	7	90	10
16	0.9	10	78.7	6.5	7	90	10
16	1	10	78.6	6.5	7	90	10
16	1.1	10	78.5	6.5	7	90	10
16	1.2	10	78.4	6.5	7	90	10
16	1.3	10	78.3	6.5	7	90	10
16	1.4	10	78.2	6.5	7	90	10
16	1.5	10	78.1	6.5	7	90	10
16	1.6	10	78	6.5	7	90	10
16	1.7	10	77.9	6.5	7	90	10
16	1.8	10	77.8	6.5	7	90	10
16	1.9	10	77.7	6.5	7	90	10
16	2	10	77.6	6.5	7	90	10
16	2.1	10	77.5	6.5	7	90	10
16	2.2	10	77.4	6.5	7	90	10
16	2.3	10	77.3	6.5	7	90	10
16	2.4	10	77.2	6.5	7	90	10
16	2.5	10	77.1	6.5	7	90	10
16	2.6	10	77	6.5	7	90	10
16	2.7	10	76.9	6.5	7	90	10
16	2.8	10	76.8	6.5	7	90	10
16	2.9	10	76.7	6.5	7	90	10
16	3	10	76.6	6.5	7	90	10
16	3.5	10	76.1	6.5	7	90	10
16	4	10	75.6	6.5	7	90	10
16	5	10	74.6	6.5	7	90	10
18	0.4	12	78.7	7.5	7	90	12
18	0.5	12	78.6	7.5	7	90	12
18	0.6	12	78.5	7.5	7	90	12
18	0.7	12	78.4	7.5	7	90	12
18	0.8	12	78.3	7.5	7	90	12

C-KC

超硬ソリッドキーシードカッター

Carbide Solid Woodruff Key-Seat Cutter

外径 φ D	刃幅 L c	柄径 φ d	柄長 (L 1)	首径 φ d 1	首長 (フラット) L 2	全長 L	刃数
18	0.9	12	78.2	7.5	7	90	12
18	1	12	78.1	7.5	7	90	12
18	1.1	12	78	7.5	7	90	12
18	1.2	12	77.9	7.5	7	90	12
18	1.3	12	77.8	7.5	7	90	12
18	1.4	12	77.7	7.5	7	90	12
18	1.5	12	77.6	7.5	7	90	12
18	1.6	12	77.5	7.5	7	90	12
18	1.7	12	77.4	7.5	7	90	12
18	1.8	12	77.3	7.5	7	90	12
18	1.9	12	77.2	7.5	7	90	12
18	2	12	77.1	7.5	7	90	12
18	2.1	12	77	7.5	7	90	12
18	2.2	12	76.9	7.5	7	90	12
18	2.3	12	76.8	7.5	7	90	12
18	2.4	12	76.7	7.5	7	90	12
18	2.5	12	76.6	7.5	7	90	12
18	2.6	12	76.5	7.5	7	90	12
18	2.7	12	76.4	7.5	7	90	12
18	2.8	12	76.3	7.5	7	90	12
18	2.9	12	76.2	7.5	7	90	12
18	3	12	76.1	7.5	7	90	12
18	3.5	12	75.6	7.5	7	90	12
18	4	12	75.1	7.5	7	90	12
18	5	12	74.1	7.5	7	90	12
19	0.4	12	88.8	8	7	100	12
19	0.5	12	88.7	8	7	100	12
19	0.6	12	88.6	8	7	100	12
19	0.7	12	88.5	8	7	100	12
19	0.8	12	88.4	8	7	100	12
19	0.9	12	88.3	8	7	100	12
19	1	12	88.2	8	7	100	12
19	1.1	12	88.1	8	7	100	12
19	1.2	12	88	8	7	100	12
19	1.3	12	87.9	8	7	100	12
19	1.4	12	87.8	8	7	100	12
19	1.5	12	87.7	8	7	100	12
19	1.6	12	87.6	8	7	100	12
19	1.7	12	87.5	8	7	100	12
19	1.8	12	87.4	8	7	100	12
19	1.9	12	87.3	8	7	100	12
19	2	12	87.2	8	7	100	12
19	2.1	12	87.1	8	7	100	12
19	2.2	12	87	8	7	100	12
19	2.3	12	86.9	8	7	100	12
19	2.4	12	86.8	8	7	100	12
19	2.5	12	86.7	8	7	100	12
19	2.6	12	86.6	8	7	100	12
19	2.7	12	86.5	8	7	100	12
19	2.8	12	86.4	8	7	100	12
19	2.9	12	86.3	8	7	100	12
19	3	12	86.2	8	7	100	12
19	3.5	12	85.7	8	7	100	12
19	4	12	85.2	8	7	100	12
19	5	12	84.2	8	7	100	12
20	0.4	12	88.8	8	7	100	12
20	0.5	12	88.7	8	7	100	12

C-KC

超硬ソリッドキーシードカッター

Carbide Solid Woodruff Key-Seat Cutter

外径 φ D	刃幅 L c	柄径 φ d	柄長 (L 1)	首径 φ d 1	首長 (フラット) L 2	全長 L	刃数
20	0.6	12	88.6	8	7	100	12
20	0.7	12	88.5	8	7	100	12
20	0.8	12	88.4	8	7	100	12
20	0.9	12	88.3	8	7	100	12
20	1	12	88.2	8	7	100	12
20	1.1	12	88.1	8	7	100	12
20	1.2	12	88	8	7	100	12
20	1.3	12	87.9	8	7	100	12
20	1.4	12	87.8	8	7	100	12
20	1.5	12	87.7	8	7	100	12
20	1.6	12	87.6	8	7	100	12
20	1.7	12	87.5	8	7	100	12
20	1.8	12	87.4	8	7	100	12
20	1.9	12	87.3	8	7	100	12
20	2	12	87.2	8	7	100	12
20	2.1	12	87.1	8	7	100	12
20	2.2	12	87	8	7	100	12
20	2.3	12	86.9	8	7	100	12
20	2.4	12	86.8	8	7	100	12
20	2.5	12	86.7	8	7	100	12
20	2.6	12	86.6	8	7	100	12
20	2.7	12	86.5	8	7	100	12
20	2.8	12	86.4	8	7	100	12
20	2.9	12	86.3	8	7	100	12
20	3	12	86.2	8	7	100	12
20	3.5	12	85.7	8	7	100	12
20	4	12	85.2	8	7	100	12
20	5	12	84.2	8	7	100	12
22	0.4	12	89.4	9	7	100	12
22	0.5	12	89.3	9	7	100	12
22	0.6	12	89.2	9	7	100	12
22	0.7	12	89.1	9	7	100	12
22	0.8	12	89	9	7	100	12
22	0.9	12	88.9	9	7	100	12
22	1	12	88.8	9	7	100	12
22	1.1	12	88.7	9	7	100	12
22	1.2	12	88.6	9	7	100	12
22	1.3	12	88.5	9	7	100	12
22	1.4	12	88.4	9	7	100	12
22	1.5	12	88.3	9	7	100	12
22	1.6	12	88.2	9	7	100	12
22	1.7	12	88.1	9	7	100	12
22	1.8	12	88	9	7	100	12
22	1.9	12	87.9	9	7	100	12
22	2	12	87.8	9	7	100	12
22	2.1	12	87.7	9	7	100	12
22	2.2	12	87.6	9	7	100	12
22	2.3	12	87.5	9	7	100	12
22	2.4	12	87.4	9	7	100	12
22	2.5	12	87.3	9	7	100	12
22	2.6	12	87.2	9	7	100	12
22	2.7	12	87.1	9	7	100	12
22	2.8	12	87	9	7	100	12
22	2.9	12	86.9	9	7	100	12
22	3	12	86.8	9	7	100	12
22	3.5	12	86.3	9	7	100	12
22	4	12	85.8	9	7	100	12
22	5	12	84.8	9	7	100	12

C-KC

超硬ソリッドキーシードカッター

Carbide Solid Woodruff Key-Seat Cutter

外径 φ D	刃幅 L c	柄径 φ d	柄長 (L 1)	首径 φ d 1	首長 (フラット) L 2	全長 L	刃数
22	6	12	83.8	9	7	100	12
25	0.4	12	89.8	10	7.5	100	14
25	0.5	12	89.7	10	7.5	100	14
25	0.6	12	89.6	10	7.5	100	14
25	0.7	12	89.5	10	7.5	100	14
25	0.8	12	89.4	10	7.5	100	14
25	0.9	12	89.3	10	7.5	100	14
25	1	12	89.2	10	7.5	100	14
25	1.1	12	89.1	10	7.5	100	14
25	1.2	12	89	10	7.5	100	14
25	1.3	12	88.9	10	7.5	100	14
25	1.4	12	88.8	10	7.5	100	14
25	1.5	12	88.7	10	7.5	100	14
25	1.6	12	88.6	10	7.5	100	14
25	1.7	12	88.5	10	7.5	100	14
25	1.8	12	88.4	10	7.5	100	14
25	1.9	12	88.3	10	7.5	100	14
25	2	12	88.2	10	7.5	100	14
25	2.1	12	88.1	10	7.5	100	14
25	2.2	12	88	10	7.5	100	14
25	2.3	12	87.9	10	7.5	100	14
25	2.4	12	87.8	10	7.5	100	14
25	2.5	12	87.7	10	7.5	100	14
25	2.6	12	87.6	10	7.5	100	14
25	2.7	12	87.5	10	7.5	100	14
25	2.8	12	87.4	10	7.5	100	14
25	2.9	12	87.3	10	7.5	100	14
25	3	12	87.2	10	7.5	100	14
25	3.5	12	86.7	10	7.5	100	14
25	4	12	86.2	10	7.5	100	14
25	5	12	85.2	10	7.5	100	14
25	6	12	84.2	10	7.5	100	14
28	0.4	12	99.4	11	8.5	110	14
28	0.5	12	99.3	11	8.5	110	14
28	0.6	12	99.2	11	8.5	110	14
28	0.7	12	99.1	11	8.5	110	14
28	0.8	12	99	11	8.5	110	14
28	0.9	12	98.9	11	8.5	110	14
28	1	12	98.8	11	8.5	110	14
28	1.1	12	98.7	11	8.5	110	14
28	1.2	12	98.6	11	8.5	110	14
28	1.3	12	98.5	11	8.5	110	14
28	1.4	12	98.4	11	8.5	110	14
28	1.5	12	98.3	11	8.5	110	14
28	1.6	12	98.2	11	8.5	110	14
28	1.7	12	98.1	11	8.5	110	14
28	1.8	12	98	11	8.5	110	14
28	1.9	12	97.9	11	8.5	110	14
28	2	12	97.8	11	8.5	110	14
28	2.1	12	97.7	11	8.5	110	14
28	2.2	12	97.6	11	8.5	110	14
28	2.3	12	97.5	11	8.5	110	14
28	2.4	12	97.4	11	8.5	110	14
28	2.5	12	97.3	11	8.5	110	14
28	2.6	12	97.2	11	8.5	110	14
28	2.7	12	97.1	11	8.5	110	14
28	2.8	12	97	11	8.5	110	14

C-KC

超硬ソリッドキーシードカッター

Carbide Solid Woodruff Key-Seat Cutter

外径 φ D	刃幅 L c	柄径 φ d	柄長 (L 1)	首径 φ d 1	首長 (フラット) L 2	全長 L	刃数
28	2.9	12	96.9	11	8.5	110	14
28	3	12	96.8	11	8.5	110	14
28	3.5	12	96.3	11	8.5	110	14
28	4	12	95.8	11	8.5	110	14
28	5	12	94.8	11	8.5	110	14
28	6	12	93.8	11	8.5	110	14
30	0.4	12	99.9	11.5	8.7	110	14
30	0.5	12	99.8	11.5	8.7	110	14
30	0.6	12	99.7	11.5	8.7	110	14
30	0.7	12	99.6	11.5	8.7	110	14
30	0.8	12	99.5	11.5	8.7	110	14
30	0.9	12	99.4	11.5	8.7	110	14
30	1	12	99.3	11.5	8.7	110	14
30	1.1	12	99.2	11.5	8.7	110	14
30	1.2	12	99.1	11.5	8.7	110	14
30	1.3	12	99	11.5	8.7	110	14
30	1.4	12	98.9	11.5	8.7	110	14
30	1.5	12	98.8	11.5	8.7	110	14
30	1.6	12	98.7	11.5	8.7	110	14
30	1.7	12	98.6	11.5	8.7	110	14
30	1.8	12	98.5	11.5	8.7	110	14
30	1.9	12	98.4	11.5	8.7	110	14
30	2	12	98.3	11.5	8.7	110	14
30	2.1	12	98.2	11.5	8.7	110	14
30	2.2	12	98.1	11.5	8.7	110	14
30	2.3	12	98	11.5	8.7	110	14
30	2.4	12	97.9	11.5	8.7	110	14
30	2.5	12	97.8	11.5	8.7	110	14
30	2.6	12	97.7	11.5	8.7	110	14
30	2.7	12	97.6	11.5	8.7	110	14
30	2.8	12	97.5	11.5	8.7	110	14
30	2.9	12	97.4	11.5	8.7	110	14
30	3	12	97.3	11.5	8.7	110	14
30	3.5	12	96.8	11.5	8.7	110	14
30	4	12	96.3	11.5	8.7	110	14
30	5	12	95.3	11.5	8.7	110	14
30	6	12	94.3	11.5	8.7	110	14
35	0.4	12	98.6	11.5	10	110	16
35	0.5	12	98.5	11.5	10	110	16
35	0.6	12	98.4	11.5	10	110	16
35	0.7	12	98.3	11.5	10	110	16
35	0.8	12	98.2	11.5	10	110	16
35	0.9	12	98.1	11.5	10	110	16
35	1	12	98	11.5	10	110	16
35	1.2	12	97.8	11.5	10	110	16
35	1.5	12	97.5	11.5	10	110	16
35	2	12	97	11.5	10	110	16
35	2.5	12	96.5	11.5	10	110	16
35	3	12	96	11.5	10	110	16
35	3.5	12	95.5	11.5	10	110	16
35	4	12	95	11.5	10	110	16
35	5	12	94	11.5	10	110	16
35	6	12	93	11.5	10	110	16
40	1	12	96.5	11.5	11.5	110	16
40	1.2	12	96.3	11.5	11.5	110	16
40	1.5	12	96	11.5	11.5	110	16

C-KC

超硬ソリッドキーシードカッター

Carbide Solid Woodruff Key-Seat Cutter

外径 φ D	刃幅 L c	柄径 φ d	柄長 (L 1)	首径 φ d 1	首長 (フラット) L 2	全長 L	刃数
40	2	12	95.5	11.5	11.5	110	16
40	2.5	12	95	11.5	11.5	110	16
40	3	12	94.5	11.5	11.5	110	16
40	3.5	12	94	11.5	11.5	110	16
40	4	12	93.5	11.5	11.5	110	16
40	5	12	92.5	11.5	11.5	110	16
40	6	12	91.5	11.5	11.5	110	16
45	1	12	106.5	11.5	11.5	120	16
45	1.2	12	106.3	11.5	11.5	120	16
45	1.5	12	106	11.5	11.5	120	16
45	2	12	105.5	11.5	11.5	120	16
45	2.5	12	105	11.5	11.5	120	16
45	3	12	104.5	11.5	11.5	120	16
45	3.5	12	104	11.5	11.5	120	16
45	4	12	103.5	11.5	11.5	120	16
45	5	12	102.5	11.5	11.5	120	16
45	6	12	101.5	11.5	11.5	120	16
50	1	12	106.5	11.5	11.5	120	18
50	1.2	12	106.3	11.5	11.5	120	18
50	1.5	12	106	11.5	11.5	120	18
50	2	12	105.5	11.5	11.5	120	18
50	2.5	12	105	11.5	11.5	120	18
50	3	12	104.5	11.5	11.5	120	18
50	3.5	12	104	11.5	11.5	120	18
50	4	12	103.5	11.5	11.5	120	18
50	5	12	102.5	11.5	11.5	120	18
50	6	12	101.5	11.5	11.5	120	18